

Spur Gears

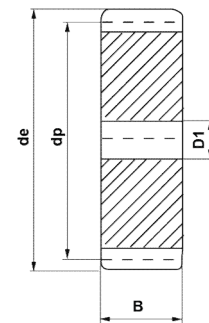

| Z | Mod.2 | | | | Mod.2.5 | | | | Mod.3 | | | |
|-----|-------|-----|----|----|---------|-------|-----|----|-------|-----|-----|----|
| | de | dp | dm | D1 | de | dp | dm | D1 | de | dp | dm | D1 |
| 12 | 28 | 24 | 18 | 10 | 35.0 | 30.0 | 22 | 10 | 42 | 36 | 27 | 12 |
| 13 | 30 | 26 | 20 | 10 | 37.5 | 32.5 | 25 | 10 | 45 | 39 | 30 | 12 |
| 14 | 32 | 28 | 22 | 10 | 40.0 | 35.0 | 28 | 10 | 48 | 42 | 33 | 12 |
| 15 | 34 | 30 | 24 | 10 | 42.5 | 37.5 | 30 | 10 | 51 | 45 | 35 | 12 |
| 16 | 36 | 32 | 25 | 10 | 45.0 | 40.0 | 32 | 12 | 54 | 48 | 38 | 14 |
| 17 | 38 | 34 | 25 | 10 | 47.5 | 42.5 | 35 | 12 | 57 | 51 | 42 | 14 |
| 18 | 40 | 36 | 25 | 10 | 50.0 | 45.0 | 35 | 12 | 60 | 54 | 45 | 14 |
| 19 | 42 | 38 | 25 | 10 | 52.5 | 47.5 | 35 | 12 | 63 | 57 | 45 | 14 |
| 20 | 44 | 40 | 30 | 10 | 55.0 | 50.0 | 40 | 12 | 66 | 60 | 45 | 14 |
| 21 | 46 | 42 | 30 | 12 | 57.5 | 52.5 | 40 | 14 | 69 | 63 | 45 | 16 |
| 22 | 48 | 44 | 30 | 12 | 60.0 | 55.0 | 45 | 14 | 72 | 66 | 50 | 16 |
| 23 | 50 | 46 | 30 | 12 | 62.5 | 57.5 | 45 | 14 | 75 | 69 | 50 | 16 |
| 24 | 52 | 48 | 35 | 12 | 65.0 | 60.0 | 45 | 14 | 78 | 72 | 50 | 16 |
| 25 | 54 | 50 | 35 | 12 | 67.5 | 62.5 | 50 | 14 | 81 | 75 | 60 | 16 |
| 26 | 56 | 52 | 40 | 12 | 70.5 | 65.0 | 50 | 14 | 84 | 78 | 60 | 16 |
| 27 | 58 | 54 | 40 | 12 | 72.5 | 67.5 | 50 | 14 | 87 | 81 | 60 | 16 |
| 28 | 60 | 56 | 40 | 12 | 75.0 | 70.0 | 50 | 14 | 90 | 84 | 60 | 16 |
| 29 | 62 | 58 | 40 | 14 | 77.5 | 72.5 | 50 | 14 | 93 | 87 | 60 | 16 |
| 30 | 64 | 60 | 40 | 14 | 80.0 | 75.0 | 55 | 14 | 96 | 90 | 60 | 16 |
| 31 | 66 | 62 | 45 | 14 | 82.5 | 77.5 | 55 | 16 | 99 | 93 | 60 | 16 |
| 32 | 68 | 64 | 45 | 14 | 85.0 | 80.0 | 55 | 16 | 102 | 96 | 70 | 16 |
| 33 | 70 | 66 | 45 | 14 | 87.5 | 82.5 | 55 | 16 | 105 | 99 | 70 | 16 |
| 34 | 72 | 68 | 45 | 14 | 90.0 | 85.0 | 55 | 16 | 108 | 102 | 70 | 16 |
| 35 | 74 | 70 | 45 | 14 | 92.5 | 87.5 | 60 | 16 | 111 | 105 | 70 | 16 |
| 36 | 76 | 72 | 45 | 14 | 95.0 | 90.0 | 60 | 16 | 114 | 108 | 70 | 20 |
| 37 | 78 | 74 | 50 | 14 | 97.5 | 92.5 | 60 | 16 | 117 | 111 | 70 | 20 |
| 38 | 80 | 76 | 50 | 14 | 100.0 | 95.0 | 60 | 16 | 120 | 114 | 80 | 20 |
| 39 | 82 | 78 | 50 | 14 | 102.5 | 97.5 | 60 | 16 | 123 | 117 | 80 | 20 |
| 40 | 84 | 80 | 50 | 14 | 105.0 | 100.0 | 70 | 16 | 126 | 120 | 80 | 20 |
| 41 | 86 | 82 | 55 | 16 | 107.5 | 102.5 | 70 | 16 | 129 | 123 | 80 | 20 |
| 42 | 88 | 84 | 55 | 16 | 110.0 | 105.0 | 70 | 16 | 132 | 126 | 80 | 20 |
| 43 | 90 | 86 | 55 | 16 | 112.5 | 107.5 | 70 | 16 | 135 | 129 | 80 | 20 |
| 44 | 92 | 88 | 60 | 16 | 115.0 | 110.0 | 70 | 16 | 138 | 132 | 90 | 20 |
| 45 | 94 | 90 | 60 | 16 | 117.5 | 112.5 | 70 | 16 | 141 | 135 | 90 | 20 |
| 46 | 96 | 92 | 60 | 16 | 120.0 | 115.0 | 70 | 16 | 144 | 138 | 90 | 20 |
| 47 | 98 | 94 | 70 | 16 | 122.5 | 117.5 | 80 | 20 | 147 | 141 | 100 | 20 |
| 48 | 100 | 96 | 70 | 16 | 125.0 | 120.0 | 80 | 20 | 150 | 144 | 100 | 20 |
| 49 | 102 | 98 | 70 | 16 | 127.5 | 122.5 | 80 | 20 | | | | |
| 50 | 104 | 100 | 70 | 16 | 130.0 | 125.0 | 80 | 20 | 156 | 150 | — | 20 |
| 51 | 106 | 102 | 70 | 16 | 132.5 | 127.5 | 80 | 20 | | | | |
| 52 | 108 | 104 | 70 | 16 | 135.0 | 130.0 | 90 | 20 | 162 | 156 | — | 20 |
| 53 | 110 | 106 | 70 | 16 | 137.5 | 132.5 | 90 | 20 | | | | |
| 54 | 112 | 108 | 70 | 16 | 140.0 | 135.0 | 90 | 20 | | | | |
| 55 | 114 | 110 | 70 | 16 | 142.5 | 137.5 | 90 | 20 | 171 | 165 | — | 20 |
| 56 | 116 | 112 | 70 | 16 | 145.0 | 140.0 | 100 | 20 | | | | |
| 57 | 118 | 114 | 70 | 16 | 147.5 | 142.5 | 100 | 20 | 177 | 171 | — | 20 |
| 58 | 120 | 116 | 70 | 16 | 150.0 | 145.0 | 100 | 20 | | | | |
| 59 | 122 | 118 | 70 | 16 | 152.5 | 147.5 | 100 | 20 | | | | |
| 60 | 124 | 120 | 70 | 16 | 155.0 | 150.0 | 100 | 20 | 186 | 180 | — | 20 |
| 61 | 126 | 122 | 80 | 16 | | | | | | | | |
| 62 | 128 | 124 | 80 | 16 | | | | | | | | |
| 63 | 130 | 126 | 80 | 16 | | | | | | | | |
| 64 | 132 | 128 | 80 | 16 | | | | | | | | |
| 65 | 134 | 130 | 80 | 16 | 167.5 | — | 20 | | 201 | 195 | — | 20 |
| 66 | 136 | 132 | 80 | 16 | | | | | | | | |
| 67 | 138 | 134 | 80 | 16 | | | | | | | | |
| 68 | 140 | 136 | 80 | 16 | | | | | | | | |
| 69 | 142 | 138 | 80 | 16 | | | | | | | | |
| 70 | 144 | 140 | 80 | 16 | 180.0 | 175.0 | — | 20 | 216 | 210 | — | 25 |
| 72 | 148 | 144 | — | 16 | 185.0 | 180.0 | — | 20 | 222 | 216 | — | 25 |
| 75 | 154 | 150 | — | 20 | 192.5 | 187.5 | — | 20 | 231 | 225 | — | 25 |
| 76 | 156 | 152 | — | 20 | 195.0 | 190.0 | — | 20 | 234 | 228 | — | 25 |
| 80 | 164 | 160 | — | 20 | 205.0 | 200.0 | — | 25 | 246 | 240 | — | 25 |
| 85 | 174 | 170 | — | 20 | 217.5 | 212.5 | — | 25 | 261 | 255 | — | 25 |
| 90 | 184 | 180 | — | 20 | 230.0 | 225.0 | — | 25 | 276 | 270 | — | 25 |
| 95 | 194 | 190 | — | 20 | 242.5 | 237.5 | — | 25 | 291 | 285 | — | 25 |
| 100 | 204 | 200 | — | 20 | 255.0 | 250.0 | — | 25 | 306 | 300 | — | 25 |
| 110 | 224 | 220 | — | 20 | 280.0 | 275.0 | — | 25 | 336 | 320 | — | 25 |
| 114 | 232 | 228 | — | 20 | 290.0 | 285.0 | — | 25 | 348 | 342 | — | 30 |
| 120 | 244 | 240 | — | 20 | 305.0 | 300.0 | — | 25 | 366 | 360 | — | 30 |

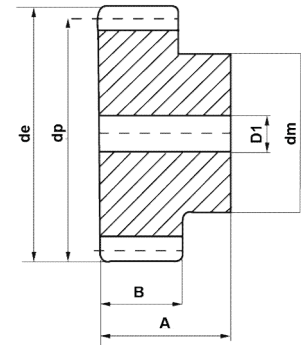

Tooth width " B "

- Module 2 =20 mm
- Module 2.5 =25 mm
- Module 3 =30 mm
- Module 4 =40 mm
- Module 5 =50 mm
- Module 6 =60 mm

Tooth width " A "

- Module 2 =35 mm
- Module 2.5 =45 mm
- Module 3 =50 mm
- Module 4 =60 mm
- Module 5 =75 mm
- Module 6 =80 mm

| Z | Mod.4 | | | | Mod.5 | | | | Mod.6 | | | |
|-----|-------|-----|----|----|-------|-----|-----|----|-------|-----|-----|----|
| | de | dp | dm | D1 | de | dp | dm | D1 | de | dp | dm | D1 |
| 12 | 56 | 48 | 35 | 14 | 70 | 60 | 45 | 20 | 84 | 72 | 54 | 20 |
| 13 | 60 | 52 | 40 | 14 | 75 | 65 | 50 | 20 | 90 | 78 | 60 | 20 |
| 14 | 64 | 56 | 45 | 14 | 80 | 70 | 55 | 20 | | | | |
| 15 | 68 | 60 | 45 | 14 | 85 | 75 | 60 | 20 | 102 | 90 | 70 | 20 |
| 16 | 72 | 64 | 50 | 16 | 90 | 80 | 65 | 20 | 108 | 95 | 75 | 20 |
| 17 | 76 | 68 | 50 | 16 | 95 | 85 | 70 | 20 | | | | |
| 18 | 80 | 72 | 50 | 16 | 100 | 90 | 70 | 20 | 120 | 108 | 80 | 20 |
| 19 | 84 | 76 | 60 | 16 | 105 | 95 | 70 | 20 | | | | |
| 20 | 88 | 80 | 60 | 16 | 110 | 100 | 80 | 20 | 132 | 120 | 90 | 20 |
| 21 | 92 | 84 | 70 | 16 | 115 | 105 | 80 | 20 | | | | |
| 22 | 96 | 88 | 70 | 16 | 120 | 110 | 80 | 20 | | | | |
| 23 | 100 | 92 | 75 | 20 | 125 | 115 | 90 | 20 | | | | |
| 24 | 104 | 96 | 75 | 20 | 130 | 120 | 90 | 20 | 156 | 144 | 110 | 25 |
| 25 | 108 | 100 | 75 | 20 | 135 | 125 | 90 | 20 | 162 | 150 | 110 | 25 |
| 26 | 112 | 104 | 75 | 20 | 140 | 130 | 100 | 20 | | | | |
| 27 | 116 | 108 | 75 | 20 | 145 | 135 | 100 | 20 | | | | |
| 28 | 120 | 112 | 75 | 20 | 150 | 140 | 100 | 25 | 180 | 168 | — | 25 |
| 29 | 124 | 116 | 75 | 20 | 155 | 145 | 110 | 25 | | | | |
| 30 | 128 | 120 | 75 | 20 | 165 | 150 | 110 | 25 | 192 | 180 | — | 25 |
| 31 | 132 | 124 | 80 | 20 | | | | | 204 | 192 | — | 25 |
| 32 | 136 | 128 | 80 | 20 | 170 | 160 | — | 25 | | | | |
| 33 | 140 | 132 | 80 | 20 | | | | | | | | |
| 34 | 144 | 136 | 80 | 20 | | | | | | | | |
| 35 | 148 | 140 | 80 | 20 | 185 | 175 | — | 25 | 222 | 210 | — | 25 |
| 36 | 152 | 144 | 80 | 25 | | | | | | | | |
| 38 | 160 | 152 | — | 25 | 200 | 190 | — | 25 | 240 | 220 | — | 25 |
| 40 | 168 | 160 | — | 25 | 210 | 200 | — | 25 | | | | |
| 45 | 188 | 180 | — | 25 | 235 | 225 | — | 25 | 252 | 240 | — | 25 |
| 48 | 200 | 192 | — | 25 | 250 | 240 | — | 25 | | | | |
| 50 | 208 | 200 | — | 25 | 260 | 250 | — | 30 | | | | |
| 52 | 216 | 208 | — | 25 | 270 | 260 | — | 30 | | | | |
| 55 | 228 | 220 | — | 25 | 285 | 275 | — | 30 | | | | |
| 57 | 236 | 228 | — | 25 | 295 | 285 | — | 30 | | | | |
| 60 | 248 | 240 | — | 25 | 310 | 300 | — | 30 | | | | |
| 65 | 268 | 260 | — | 25 | 335 | 325 | — | 30 | | | | |
| 70 | 288 | 280 | — | 25 | 360 | 350 | — | 30 | | | | |
| 75 | 308 | 300 | — | 25 | 385 | 375 | — | 30 | | | | |
| 76 | 312 | 304 | — | 30 | 390 | 380 | — | 30 | | | | |
| 80 | 328 | 320 | — | 30 | 410 | 400 | — | 30 | | | | |
| 85 | 348 | 340 | — | 30 | 435 | 425 | — | 30 | | | | |
| 90 | 368 | 360 | — | 30 | 460 | 450 | — | 30 | | | | |
| 95 | 388 | 380 | — | 30 | 485 | 475 | — | 30 | | | | |
| 100 | 408 | 400 | — | 30 | 510 | 500 | — | 30 | | | | |
| 110 | 448 | 440 | — | 30 | 560 | 550 | — | 30 | | | | |
| 114 | 464 | 456 | — | 30 | 580 | 570 | — | 30 | | | | |

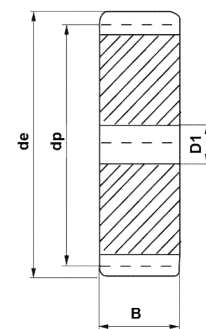
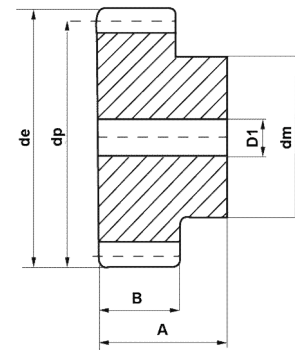

Tooth width " B "

- Module 2 =20 mm
- Module 2.5 =25 mm
- Module 3 =30 mm
- Module 4 =40 mm
- Module 5 =50 mm
- Module 6 =60 mm

Tooth width " A "

- Module 2 =35 mm
- Module 2.5 =45 mm
- Module 3 =50 mm
- Module 4 =60 mm
- Module 5 =75 mm
- Module 6 =80 mm

Material selection: Steel C45, 42CrMo, 20CrMnTi.
 Surface treatment selection: Hardening teeth, Oil, Black oxide, Carburizing.
 For large module gears, or custom made gears, pls contact Fekerman directly.